

ACCESORIOS PP-R
PP-R-FITTINGS

CODO 90° HEMBRA/HEMBRA

FEMALE/FEMALE
90° ELBOW

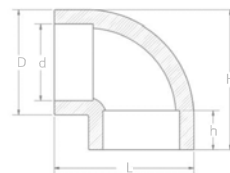

	código	∅	d	D	h	H	L	uds.bolsa	uds.caja	peso (gr)	€/U
	code	(mm)	(mm)	(mm)	(mm)	(mm)	(mm)	units bag	units box	weight (gr)	€/U
SOLDADURA SOCKET	822001616	16	16	24,5	13	33,5	33,5	10	150	1.695	0,531
	822002020	20	20	28,8	15,5	39,2	40,2	10	150	2.295	0,562
	822002525	25	25	34,5	16	44,5	46	10	100	2.390	0,711
	822003232	32	32	42,3	18,4	59,9	55,6	10	50	1.965	1,187
	822004040	40	40	54,9	21,6	71,3	71,5	6	24	2.105	2,340
	822005050	50	50	68,5	23,5	83	83	4	12	2.160	4,717
	822006363	63	63	84,5	27,5	101	100	2	6	1.620	7,407
	822007575	75	75	99,5	30	119,5	119	1	3	1.375	12,083
	822009090	90	90	120,4	35,9	142,2	142,6	1	3	2.730	22,845
	822110110	110	110	146,5	37	172	176,5	1	2	3.195	41,982
	822125125	125	125	162	40	181	181	1	2	3.400	59,970
	822160160	160	160	199,5	43,2	226	226	1	1	2.734	97,064

CODO 90° INYECTADO SOLDADURA TOPE LARGO

LONG 90° ELBOW
BUTT WELDING

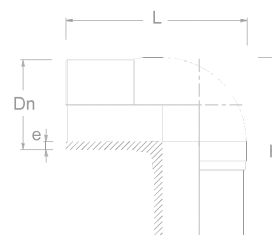

	código	∅	Dn	e	H	L	uds.bolsa	uds.caja	peso (gr)	€/U
	code	(mm)	(mm)	(mm)	(mm)	(mm)	units bag	units box	weight (gr)	€/U
PP-R SDR11	822B00160	160	160	14,6	282,8	282,8	1	3	1.922	197,668
	822B00200	200	200	18,20	354	354	1	3	8.140	395,675
	822B00250	250	250	22,70	435	435	1	1	18.000	689,631

CODO 90° SEGMENTADO SOLDADURA A TOPE

SEGMENTED 90°
ELBOW BUTT WELDING

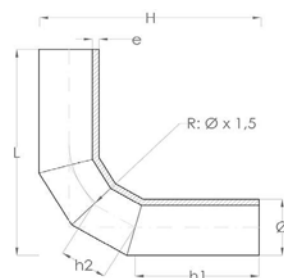

	código	∅	R	e	h1	h2	L = H	uds.bolsa	uds.caja	peso (gr)	€/U
	code	(mm)	(mm)	(mm)	(mm)	(mm)	(mm)	units bag	units box	weight (gr)	€/U
PP-RP SDR11	*822C00200	200	300	18,2	231	159	548	1	3	8.140	558,798
	*822C00250	250	375	22,7	351	198	746	1	1	18.000	866,144
	*822C00315	315	472,5	28,6	427	250	926	1	1	37.850	1.205,557
	*822C00355	355	532,5	32,2	443	281	1004	1	1	50.400	1.562,360
	*822C00400	400	600	36,3	461	317	1094	1	1	62.800	1.997,646
PP-RP SDR17	822C00126	125	187,5	7,40	200	99	397	1	1	0.950	(1)
	822C00161	160	240	9,50	215	127	468	1	1	1.570	(1)
	822C00201	200	300	11,9	231	159	548	1	1	5.712	(1)
	822C00251	250	375	14,8	351	198	746	1	1	13.000	(1)
	822C00316	315	472,5	18,7	427	250	926	1	1	24.000	(1)
	822C00356	355	532,5	21,1	443	281	1004	1	1	32.000	(1)
	822C00401	400	600	23,7	461	317	1094	1	1	42.549	(1)

(*) Bajo demanda / (*) On request

(1) Bajo demanda. Consultar precio y disponibilidad. / (1) On request. Check availability and price.
 ****REBOCA se reserva el derecho de suministrar accesorios inyectados o semi-elaborados según disponibilidad
 *** REBOCA reserves the right to supply injected or semi-finished accessories according to availability"

CODO 60° SEGMENTADO SOLDADURA A TOPE

SEGMENTED 60°
ELBOW BUTT WELDING

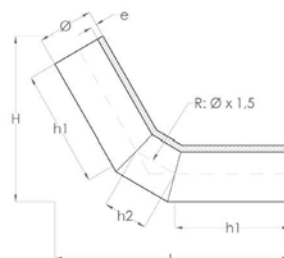

	código	∅	R	e	h1	h2	L	H	uds.bolsa	uds.caja	peso (gr)	€/U
	code	(mm)	(mm)	(mm)	(mm)	(mm)	(mm)	(mm)	units bag	units box	weight (gr)	€/U
PP-R & PP-RP SDR11	822C10125	125	187,5	11,4	200	101	441,6	317,5	1	1	1.274	(1)
	822C10160	160	240	14,6	215	129	502	370	1	1	1.769	(1)
	822C10200	200	300	18,2	231	161	572	430	1	1	7.489	(1)
	822C10250	250	375	22,7	351	201	808	592	1	1	16.560	(1)
	822C10315	315	472,5	28,6	427	253	996	733	1	1	34.822	(1)
	822C10355	355	532,5	32,2	443	285	1.065	793	1	1	46.368	(1)
	822C10400	400	600	36,3	461	322	1.143	860	1	1	57.776	(1)
PP-RP SDR17	822C10126	125	187,5	7,40	200	101	441,6	317,5	1	1	874	(1)
	822C10161	160	240	9,50	215	129	502	370	1	1	1.444	(1)
	822C10201	200	300	11,9	231	161	572	430	1	1	5.255	(1)
	822C10251	250	375	14,8	351	201	808	592	1	1	11.960	(1)
	822C10316	315	472,5	18,7	427	253	996	733	1	1	22.080	(1)
	822C10356	355	532,5	21,1	443	285	1.065	793	1	1	29.440	(1)
	822C10401	400	600	23,7	461	322	1.143	860	1	1	39.145	(1)

(1) Bajo demanda. Consultar precio y disponibilidad. / (1) On request. Check availability and price.

REPOLEN

COMERCIAL DE FONTANERÍA
oneval

Comercial de Fontanería Neval, S. L.

Pol. Industrial de Vicálvaro, C/ Fundiciones 7 - 28052 MADRID

Tel: 91 3800 900 · Fax: 91 760 41 54 · cfneval@cfneval.com · pedidos@cfneval.com · www.cfneval.com

CODO 45° HEMBRA/HEMBRA

FEMALE/FEMALE
45° ELBOW

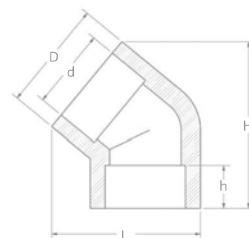

	código	∅	d	D	h	H	L	uds.bolsa	uds.caja	peso (gr)	€/U
	code	(mm)	(mm)	(mm)	(mm)	(mm)	(mm)	units bag	units box	weight (gr)	€/U
SOLDADURA SOCKET	823001616	16	16	25	13	36	32	10	150	1.448	0,642
	823002020	20	20	30	14,5	46	39	10	100	1.955	0,791
	823002525	25	25	36	16	60	50	10	80	1.755	0,894
	823003232	32	32	45	18	72	60	10	40	2.010	1,254
	823004040	40	40	55,5	20,5	83	71	6	24	2.140	2,606
	823005050	50	50	65,5	23,5	89,5	79	4	15	2.040	4,109
	823006363	63	63	84	27,5	97	96,5	2	8	1.773	7,656
	823007575	75	75	98,5	30	114,5	115	1	4	1.450	10,410
	823009090	90	90	121,5	33	133	139	1	3	1.857	24,690
	823110110	110	110	150	37	167,5	173	1	2	2.447	38,017
	823125125	125	125	162	40	184,5	188	1	2	3.100	59,993
823160160	160	160	196	43,2	211,5	221,5	1	1	1.737	97,025	

CODO 45° INYECTADO SOLDADURA TOPE LARGO

LONG ELBOW 45°
FOR BUTT FUSION

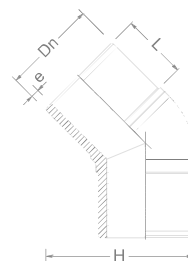

	código	∅	Dn	e	H	L	uds.bolsa	uds.caja	peso (gr)	€/U
	code	(mm)	(mm)	(mm)	(mm)	(mm)	units bag	units box	weight (gr)	€/U
PP-R SDR11	823B00160	160	160	16,7	298	103	1	5	1.393	147,266
	823B00200	200	200	18,20	402	117	1	3	5.735	313,900
	823B00250	250	250	22,70	462	250	1	1	13.000	472,440



CODO 45° SEGMENTADO SOLDADURA A TOPE

ELBOW 45° SEGMENT WELDED FOR BUTT FUSION

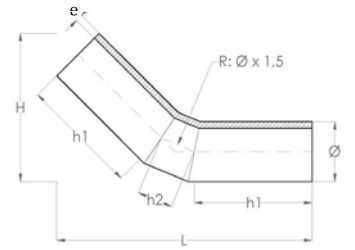

	código	Ø (mm)	R (mm)	e (mm)	h1 (mm)	h2 (mm)	L (mm)	H (mm)	uds.bolsa	uds.caja	peso (gr)	€/U
	code								units bag	units box	weight (gr)	€/U
PP-R & PP-PP-SDRT1	*823C00200	200	300	18,20	210	120	539	365	1	3	6.865	392,649
	*823C00250	250	375	22,70	325	149	783	500	1	1	16.000	626,207
	*823C00315	315	472,5	28,60	394	188	958	620	1	1	27.300	964,553
	*823C00355	355	532,5	32,20	406	212	1.015	672	1	1	36.100	1.145,650
	*823C00400	400	600	36,30	419	239	1.078	730	1	1	44.712	1.494,631
PP-PP-SDRT7	*823C00126	125	187,5	7,40	187	75	432,7	267,6	1	1	1.150	175,250
	*823C00161	160	240	9,50	198	95	483	313	1	1	1.730	265,520
	*823C00201	200	300	11,9	210	120	539	365	1	1	3.672	375,450
	*823C00251	250	375	14,8	325	149	783	500	1	1	9.400	485,650
	*823C00316	315	472,5	18,7	394	188	958	620	1	1	18.000	765,250
	*823C00356	355	532,5	21,1	406	212	1.015	672	1	1	22.058	975,250
	*823C00401	400	600	23,7	419	239	1.078	730	1	1	30.800	1.275,650

(*) Bajo demanda / (*) On request

****REBOCA se reserva el derecho de suministrar accesorios inyectados o semi-elaborados según disponibilidad
 *** REBOCA reserves the right to supply injected or semi-finished accessories according to availability"

CODO 30° SEGMENTADO SOLDADURA A TOPE

SEGMENTED ELBOW BUTT WELDING

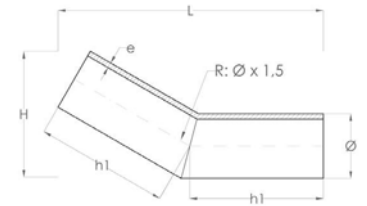

	código	Ø (mm)	R (mm)	e (mm)	h1 (mm)	L (mm)	H (mm)	uds.bolsa	uds.caja	peso (gr)	€/U
	code							units bag	units box	weight (gr)	€/U
PP-R & PP-PP-SDRT1	822C20125	125	187,5	11,4	200	404,5	216,6	1	1	1.334	(1)
	822C20160	160	240	14,6	214,5	441,2	256,8	1	1	1.885	(1)
	822C20200	200	300	18,2	230,5	481,1	302,1	1	1	6.316	(1)
	822C20250	250	375	22,7	350,5	715	410	1	1	14.720	(1)
	822C20315	315	472,5	28,6	426,5	875	507	1	1	25.116	(1)
	822C20355	355	532,5	32,2	443	915	553	1	1	33.212	(1)
	822C20400	400	600	36,3	461	960	606	1	1	41.135	(1)
	822C20126	125	187,5	7,40	200	404,5	216,6	1	1	1.058	(1)
PP-R & PP-PP-SDRT7	822C20161	160	240	9,50	214,5	441,2	256,8	1	1	1.592	(1)
	822C20201	200	300	11,9	230,5	481,1	302,1	1	1	3.379	(1)
	822C20251	250	375	14,8	350,5	715	410	1	1	8.648	(1)
	822C20316	315	472,5	18,7	426,5	875	507	1	1	16.560	(1)
	822C20356	355	532,5	21,1	443	915	553	1	1	20.294	(1)
	822C20401	400	600	23,7	461	960	606	1	1	28.336	(1)

(1) Bajo demanda. Consultar precio y disponibilidad./ (1) On request. Check availability and price.

MANGUITO

SOCKET

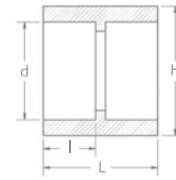

código	∅	d	H	l	L	uds.bolsa	uds.caja	peso (gr)	€/U
code	(mm)	(mm)	(mm)	(mm)	(mm)	units bag	units box	weight (gr)	€/U
821001616	16	16	24,5	13	30	10	150	1.314	0,437
821002020	20	20	29,5	14,5	34,5	10	150	2.065	0,508
821002525	25	25	33	16	37	10	100	1.565	0,618
821003232	32	32	43,5	18	42,5	10	70	2.155	0,844
821004040	40	40	52	20,5	46	6	42	1.925	1,632
821005050	50	50	68,5	23,5	55,5	3	18	1.860	3,202
821006363	63	63	83,5	27,5	61,5	3	15	2.245	4,426
821007575	75	75	99	30	66,5	2	10	2.270	7,402
821009090	90	90	119	33	74	2	6	2.220	12,757
821110110	110	110	154,5	37	88	1	4	3.190	23,353
821125125	125	125	163	40	90	1	2	1.641	30,673
821160160	160	160	201	43,2	101,5	1	1	1.314	57,534

REDUCCIÓN MACHO - HEMBRA

FEMALE - FEMALE
REDUCER PIPE

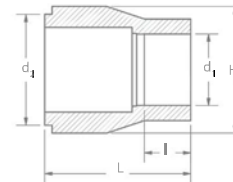

código	∅	d2	d1	H	l	L	uds.bolsa	uds.caja	peso (gr)	€/U
code	(mm)	(mm)	(mm)	(mm)	(mm)	(mm)	units bag	units box	weight (gr)	€/U
820012016	20x16	20	16	22	13	32,5	10	150	1.095	0,503
820012516	25x16	25	16	26	13	38	10	150	1.917	0,508
820012520	25x20	25	20	27	14,5	38,5	10	150	1.680	0,536
820013220	32x20	32	20	32,5	14,5	37,5	10	150	2.004	0,704
820013225	32x25	32	25	33	16	45	10	100	1.866	0,708
820014020	40x20	40	20	41	14,5	44	6	60	1.845	1,451
820014025	40x25	40	25	41	16	49	6	60	2.024	1,444
820014032	40x32	40	32	43	18	49	6	60	2.350	1,620
820015020	50x20	50	20	50,5	14,5	53,5	3	36	1.571	2,775
820015025	50x25	50	25	50	16	53	3	36	1.552	2,775
820015032	50x32	50	32	50,5	18	53,5	3	36	1.789	2,775
820015040	50x40	50	40	52	20,5	56	3	30	1.870	2,785
820016320	63x20	63	20	63,5	14,5	64	3	30	2.250	3,906
820016325	63x25	63	25	63,5	16	63,5	3	30	2.314	3,906
820016332	63x32	63	32	63,5	18	63,5	3	30	2.438	3,906
820016340	63x40	63	40	63,5	20,5	64	3	24	2.210	4,916
820016350	63x50	63	50	68,5	23,5	63,5	3	15	1.690	4,959
820017525	75x25	75	25	75,5	16	59,5	2	20	2.220	5,231
820017532	75x32	75	32	75,5	18	66,5	2	20	2.390	5,231
820017540	75x40	75	40	76	20,5	67	2	20	2.470	5,231
820017550	75x50	75	50	75,5	23,5	66,5	2	16	2.155	5,231
820017563	75x63	75	63	84,5	27,5	69,5	2	16	2.805	6,509
820019050	90x50	90	50	90	23,8	74	1	10	2.250	12,925
820019063	90 x 63	90	63	90	27,5	76	2	8	1.853	12,048
820019075	90 x 75	90	75	99,5	30	79,5	1	8	2.335	12,048
820011063	110 x 63	110	63	110	27,5	84	1	3	1.101	13,397
820011075	110 x 75	110	75	110,5	30	89	1	3	1.250	13,397
820011090	110 x 90	110	90	118,5	33	98,5	1	3	1.630	17,439
820012575	125 x 75	125	75	125,5	30	102	1	3	1.737	64,352
820012590	125 x 90	125	90	99,5	33	125	1	3	1.830	64,352
820012511	125x110	125,6	109,6	147,5	37	113,2	1	3	2.250	65,566





REDUCCIÓN HEMBRA - HEMBRA

FEMALE - FEMALE
REDUCER PIPE

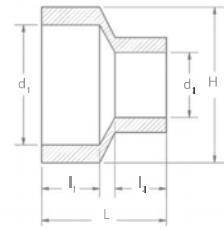

código	∅	d1	d2	H	l1	l2	L	uds.bolsa	uds.caja	peso (gr)	€/U
code	(mm)	(mm)	(mm)	(mm)	(mm)	(mm)	(mm)	units bag	units box	weight (gr)	€/U
820002016	20x16	20	16	29	14,5	13	34,5	10	100	1.246	0,739
820002516	25x16	25	16	35	16	13	37,5	10	100	1.553	0,739
820002520	25x20	25	20	33,2	17,6	15	37,4	10	100	1.400	1,461
820003220	32x20	32	20	41,5	18	14,5	40	10	100	1.955	1,500
820003225	32x25	32	25	41,5	18	16	42	10	90	2.160	1,503
820004020	40x20	40	20	51	20,5	14,5	43	6	60	1.862	1,624
820004025	40x25	40	25	51,5	20,5	16	45	6	60	1.997	1,624
820004032	40x32	40	32	51	20,5	18	45	6	60	2.080	1,624
820005040	50x40	50	40	68,5	23,5	20,5	59,5	3	15	1.700	4,010
820006350	63x50	63	50	83	27,5	23,5	61	3	15	2.625	6,013
820007563	75x63	75	63	99	30	27,5	66	2	8	2.069	10,584
820009075	90 x 75	90	75	119,5	33	30	72	2	6	2.565	17,723
820012510	125 x 110	125	110	161	40	37	93,5	1	3	2.208	56,708
820016011	160 x 110	160	110	199	43,2	37	99,5	1	1	1.268	58,743
820016025	160 x 125	160	125	167	39,2	40	90,00	1	1	2.200	76,978

REDUCCIÓN MACHO- MACHO SOLDADURA TOPE LARGO

LONG MALE-MALE
REDUCER PIPE
BUTT WELDING

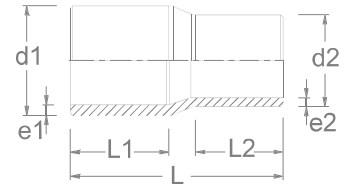

	código	∅	d1	d2	e1	e2	L1	L2	L	uds.bolsa	uds.caja	peso (gr)	€/U
	code	(mm)	(mm)	(mm)	(mm)	(mm)	(mm)	(mm)	(mm)	units bag	units box	weight (gr)	€/U
PP-R SDR11	820016010	160x110	160	110	14,60	10,0	103,12	87,88	214,88	1	1	595	91,861
	820016013	160x125	160	125	14,60	11,4	102,11	90,93	214,12	1	1	705	98,545
	820020011	200x110	200	110	18,20	10,0	110,00	93,5	224,00	1	1	1.250	140,936
	820020012	200x125	200	125	18,20	11,4	110,00	97,8	228,50	1	1	1.358	155,782
	820020016	200x160	200	160	18,20	14,60	118,11	101,09	240,03	1	1	1.163	152,754
	820025016	250x160	250	160	22,70	18,20	245,11	175,00	500,12	1	1	3.472	302,787
	820025020	250x200	250	200	22,70	22,70	245,11	184,91	510,03	1	1	2.341	323,814
	820031520	315x200	315	200	28,70	18,20	320,00	184,91	584,71	1	1	3.412	628,038
	820031525	315x250	315	250	28,70	22,70	320,00	245,11	644,91	1	1	4.650	684,295

TE LISA HEMBRA

FEMALE TEE

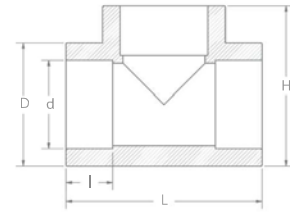

	código	∅	d	D	H	I	L	uds.bolsa	uds.caja	peso (gr)	€/U
	code	(mm)	(mm)	(mm)	(mm)	(mm)	(mm)	units bag	units box	weight (gr)	€/U
SOLDADURA SOCKET	824001616	16	16	25,5	34	13	43,5	10	100	1.700	0,550
	824002020	20	20	30,5	41	14,5	52,5	10	80	1.995	0,669
	824002525	25	25	35	48	16	61	10	60	2.188	0,816
	824003232	32	32	45	58,5	18	74,5	5	30	2.014	1,568
	824004040	40	40	55	70	20,5	86	6	18	2.090	2,791
	824005050	50	50	69,5	84	23,5	98	2	12	2.360	5,139
	824006363	63	63	83,5	101,5	27,5	115	1	6	1.910	9,644
	824007575	75	75	98	116,5	30	138,5	1	3	1.525	11,573
	824009090	90	90	123	138,5	33	157,5	1	3	2.830	24,571
	824110110	110	110	145	166,5	37	192,5	1	1	1.617	44,124
	824125125	125	125	164,5	182	40	208	1	1	1.907	66,256
824160160	160	160	201	223,5	43,2	259	1	1	3.206	127,574	

TE LISA SOLDADURA A TOPE

TEE BUTT WELDING

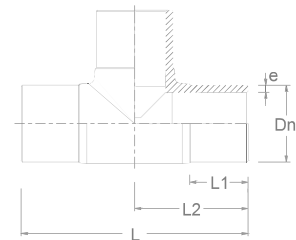

	código	∅	Dn	e	L1	L2	L	uds.bolsa	uds.caja	peso (gr)	€/U
	code	(mm)	(mm)	(mm)	(mm)	(mm)	(mm)	units bag	units box	weight (gr)	€/U
PP-R SDR11	824B00160	160	160	14,60	110,0	217,0	434,0	1	3	2.777	235,780
	824B00200	200	200	18,20	117,0	250,0	500,0	1	1	6.865	398,969
	824B00250	250	250	22,70	135,0	305,0	610,0	1	1	16.00	639,200



TE LISA SEGMENTADA SOLDADURA A TOPE

SEGMENTED TEE BUTT WELDING

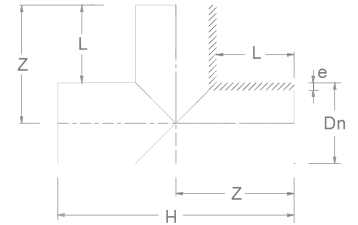
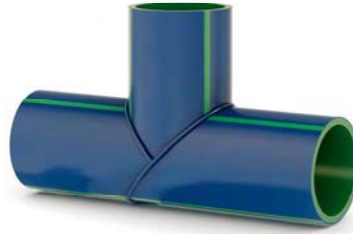

	código	∅	Dn	e	z	L	H	uds.bolsa	uds.caja	peso (gr)	€/U
	code	(mm)	(mm)	(mm)	(mm)	(mm)	(mm)	units bag	units box	weight (gr)	€/U
PP-RP SDR11	*824C00200	200	200	18,20	300	200	600	1	1	8.171	448,389
	*824C00250	250	250	22,70	375	250	750	1	1	18.827	741,020
	*824C00315	315	315	28,60	472,5	315	945	1	1	36.674	1.195,945
	*824C00355	355	355	32,20	532,5	355	1065	1	1	49.400	1.360,550
	*824C00400	400	400	36,30	600	400	1200	1	1	62.100	1.666,414
PP-RP SDR17	*824C00126	125	125	7,40	185	122,5	370	1	1	1.750	149,650
	*824C00161	160	160	9,50	240	160	480	1	1	2.716	238,400
	*824C00201	200	200	11,9	300	200	600	1	1	4.660	274,850
	*824C00251	250	250	14,8	375	250	750	1	1	11.500	429,550
	*824C00316	315	315	18,7	472,5	315	945	1	1	19.800	734,880
	*824C00356	355	355	21,1	532,5	355	1065	1	1	27.500	989,690
	*824C00401	400	400	23,7	600	400	1200	1	1	40.395	1.355,000

(*) Bajo demanda / (*) On request
 ***REBOCA se reserva el derecho de suministrar accesorios inyectados o semi-elaborados según disponibilidad
 ***REBOCA reserves the right to supply injected or semi-finished accessories according to availability

** TE 45° SEGMENTADA SOLDADURA A TOPE

** SEGMENTED 45° TEE
BUTT WELDING

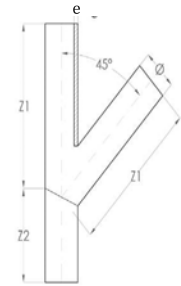

	código	∅	Dn	e	Z1	Z2	uds.bolsa	uds.caja	peso (gr)	€/U
	code	(mm)	(mm)	(mm)	(mm)	(mm)	units bag	units box	weight (gr)	€/U
PP-R & PP-RP SDR11	824C30125	125	125	11,4	450	255	1	1	1.755	(1)
	824C30160	160	160	14,6	500	276	1	1	2.555	(1)
	824C30200	200	200	18,2	650	300	1	1	7.517	(1)
	824C30250	250	250	22,7	700	450	1	1	17.321	(1)
	824C30315	315	315	28,6	700	549	1	1	31.041	(1)
PP-RP SDR17	824C30126	125	125	7,4	450	255	1	1	1.610	(1)
	824C30161	160	160	9,5	500	276	1	1	2.499	(1)
	824C30201	200	200	11,9	650	300	1	1	4.287	(1)
	824C30251	250	250	14,8	700	450	1	1	10.580	(1)
	824C30316	315	315	18,7	700	549	1	1	18.216	(1)

(1) Bajo demanda. Consultar precio y disponibilidad. / (1) On request. Check availability and price.
 ** Consultar la disponibilidad y montaje de otros accesorios especiales / Check the availability and assembly of other special accessories.

TE REDUCIDA HEMBRA

REDUCER
FEMALE TEE

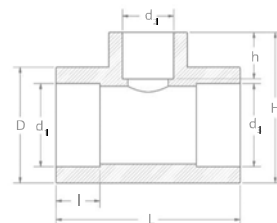

código	∅	d1	d2	d3	D	h	H	l	L	uds.bolsa	uds.caja	peso (gr)	€/U
code	(mm)	(mm)	(mm)	(mm)	(mm)	(mm)	(mm)	(mm)	(mm)	units bag	units box	weight (gr)	€/U
825162016	16x20x16	16	20	16	35	14,5	49,5	13	62,5	10	50	2.613	0,900
825201616	20x16x16	20	16	16	30	13	43,5	14,5	52,5	10	50	1.527	0,900
825201620	20x16x20	20	16	20	30	13	44	14,5	52,5	10	50	1.448	0,900
825202016	20x20x16	20	20	16	30	14,5	44	14,5	52	10	50	1.454	0,900
825202025	20x20x25	20	20	25	35	14,5	49,5	14,5	63	10	50	2.205	1,306
825202520	20x25x20	20	25	20	35	16	49	14,5	62,5	10	50	2.166	1,306
825251625	25x16x25	25	16	25	35,5	13	49	16	63	10	50	2.108	1,325
825252025	25x20x25	25	20	25	35	14,5	49,5	16	62,5	10	60	2.425	1,306
825202525	20x25x25	20	25	25	35,5	16	50	14,5	63	10	50	2.035	1,306
825253225	25x32x25	25	32	25	43,5	18	58	16	74,5	10	30	2.171	2,378
825322025	32x20x25	32	20	25	43	14,5	58	18	74,5	10	30	2.251	2,378
825322525	32x25x25	32	25	25	43	16	58	18	74,5	5	30	2.240	2,378
825322032	32x20x32	32	20	32	43	14,5	58	18	74,5	5	30	2.040	2,413
825322532	32x25x32	32	25	32	43	16	58,5	18	74,5	5	30	1.955	2,424
825402040	40x20x40	40	20	40	53,5	14,5	73	20,5	86,5	6	18	2.057	3,196
825402540	40x25x40	40	25	40	55	16	73	20,5	86,5	6	18	1.870	3,196
825403240	40x32x40	40	32	40	55	18	70,5	20,5	86	6	18	2.210	3,196
825502050	50x20x50	50	20	50	65,5	14,5	71,5	23,5	96	2	12	1.820	5,267
825502550	50x25x50	50	25	50	65,5	16	76,5	23,5	95,5	2	12	1.765	5,267
825503250	50x32x50	50	32	50	66	18	76	23,5	96	2	12	1.835	5,267
825504050	50x40x50	50	40	50	68,5	20,5	85	23,5	98,5	2	12	2.529	5,577
825632063	63x20x63	63	20	63	83	14,5	88	27,5	116	2	8	2.290	9,023
825632563	63x25x63	63	25	63	82,5	16	87,5	27,5	115,5	2	8	2.350	9,023
825633263	63x32x63	63	32	63	82,5	18	92,5	27,5	115,5	2	6	1.743	9,023
825634063	63x40x63	63	40	63	83	20,5	92,5	27,5	115	2	6	1.750	9,023
825635063	63x50x63	63	50	63	83	23,5	95,5	27,5	115	2	6	1.795	9,288
825752075	75x20x75	75	20	75	98	14,5	105,5	30	126,5	1	4	1.957	17,701
825752575	75x25x75	75	25	75	98,5	16	106	30	126,5	1	4	1.941	17,701
825753275	75x32x75	75	32	75	98,5	18	106	30	127	1	4	1.980	17,701
825754075	75x40x75	75	40	75	100	20,5	108,5	30	126	1	4	1.989	17,701
825755075	75x50x75	75	50	75	99	23,5	109	30	126,5	1	3	1.550	17,701
825756375	75x63x75	75	63	75	98,5	27,5	116	30	137,5	1	3	1.785	18,221
825905090	90x50x90	90	50	90	122	23,5	133,5	33	157,5	1	3	1.938	28,274
825906390	90x63x90	90	63	90	121	27,5	134	33	157,5	1	3	2.840	28,274
825907590	90x75x90	90	75	90	122	30	138,5	33	157,5	1	3	3.066	28,274
825011050	110x50x110	110	50	110	146,5	23,5	158,5	37	174,5	1	2	2.617	39,188
825011063	110x63x110	110	63	110	147	27,5	149,5	37	175	1	2	2.580	39,188
825011075	110x75x110	110	75	110	147,5	30	163	37	177,5	1	2	2.827	39,188
825011090	110x90x110	110	90	110	148,5	33	164	37	177,5	1	2	2.653	39,188
825012575	125x75x125	125	75	125	167,5	30	191	40	230	1	2	5.083	103,483
825012590	125x90x125	125	90	125	167,5	33	191	40	229	1	2	5.139	103,483
825125110	125x110x125	125	110	125	167,5	37	197	40	229,5	1	2	5.273	103,483





TE REDUCIDA: TUBO - DERIVACIÓN MACHO

SADDLE REDUCED TEE

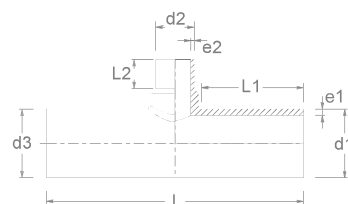

TIPO A / TYPE A

	código	*** TIPO	Ø (mm)	d1 (mm)	e1 (mm)	d2 (mm)	e2 (mm)	L (mm)	Z (mm)	h (mm)	uds.bolsa	uds.caja	peso (gr)	€/U
	code	*** TYPE									units bag	units box	weight (gr)	€/U
PP-R & PP-SDRT1	825160063	A	160x63x160	160	14,6	63	5,8	340	141,0	35	1	1	3.050	257,433
	825160075	A	160x75x160			75	6,8	340	209,0	75	1	1	3.140	267,368
	825160090	A	160x90x160			90	8,2	340	209,0	75	1	1	3.176	277,651
	825160110	A	160x110x160			110	10,0	340	209,0	75	1	1	3.250	294,773
	825200063	A	200x63x200	200	18,2	63	5,8	380	161,0	35	1	1	4.300	283,908
	825200075	A	200x75x200			75	6,8	380	229,0	75	1	1	5.460	284,514
	825200090	A	200x90x200			90	8,2	380	229,0	75	1	1	5.168	298,739
	825200110	A	200x110x200			110	10,0	380	229,0	75	1	1	5.810	324,666
	825250075	A	250x75x250	250	22,7	75	6,8	420	254,0	75	1	1	5.460	367,375
	825250090	A	250x90x250			90	8,2	420	254,0	75	1	1	12.420	383,924
	825250110	A	250x110x250			110	10,0	420	254,0	75	1	1	12.760	452,638
	825315075	A	315x75x315			315	28,6	75	6,8	460	286,5	75	1	1
	825315090	A	315x90x315	90	8,2			460	286,5	75	1	1	22.250	567,851
	825315110	A	315x110x315	110	10,0			460	286,5	75	1	1	23.500	593,255
	*825400075	A	400x75x400	400	36,3			75	6,8	460	329,0	75	1	1
	*825400090	A	400x90x400			90	8,2	460	329,0	75	1	1	35.500	643,240
*825400110	A	400x110x400	110			10,0	460	329,0	75	1	1	37.150	673,680	

(*) Bajo demanda / (*) On request

TE REDUCIDA LARGA: TE LISA INYECTADA - REDUCCIÓN

LONG REDUCER TEE: INJECTED TEE-REDUCER

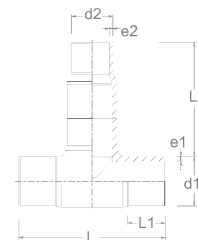

TIPO B / TYPE B

	código	TIPO	Ø (mm)	d1 (mm)	e1 (mm)	d2 (mm)	e2 (mm)	L1 (mm)	L2 (mm)	L (mm)	uds.bolsa	uds.caja	peso (gr)	€/U
	code	TYPE									units bag	units box	weight (gr)	€/U
PP-R SDRT1	*825160125	B	160x125x160	160	14,6	125	11,4	110,0	374,0	434,0	1	1	3.750	359,633
	*825200160	B	200x160x200	200	18,2	160	14,6	117,0	440,0	500,0	1	1	7.650	569,400
	*825250200	B	250x200x250	250	22,7	200	18,2	135,0	760,0	610,0	1	1	21.100	946,050

TE REDUCIDA: TUBO - TUBO

REDUCED TEE BUTT
WELD PIPE WITH PIPE

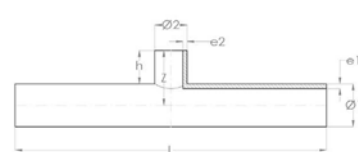
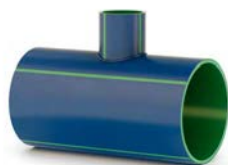

TIPO C / TYPE C

	código	*** TIPO	Ø	d1	e1	d2	e2	L	Z	H	uds.bolsa	uds.caja	peso (gr)	€/U
	code	*** TYPE	(mm)	(mm)	(mm)	(mm)	(mm)	(mm)	(mm)	(mm)	units bag	units box	weight (gr)	€/U
PP-R & PP-RP SDR11	*825200125	C	200x125x200	200	18,2	125	11,4	460,0	425,0	300,0	1	1	6.100	367,000
	*825250125	C	250x125x250	250	22,7	125	11,4	460,0	425,0	300,0	1	1	13.030	415,000
	*825250160	C	250x160x250			160	14,6	460,0	425,0	300,0	1	1	19.500	485,050
	*825315125	C	315x125x315	315	28,6	125	11,4	480,0	457,5	300,0	1	1	25.000	527,650
	*825315160	C	315x160x315			160	14,6	480,0	457,5	300,0	1	1	26.850	551,890
	*825355125	C	355x125x355	355	32,2	125	11,4	480,0	507,5	330,0	1	1	32.500	589,210
	*825355160	C	355x160x355			160	14,6	480,0	507,5	330,0	1	1	34.893	607,650
	*825400125	C	400x125x400	400	36,3	125	11,4	480,0	560,0	360,0	1	1	42.100	688,270
	*825400160	C	400x160x400			160	14,6	480,0	560,0	360,0	1	1	44.120	698,580
PP-RP SDR17	825200126	C	200x125x200	200	11,9	125	7,4	460,0	425,0	300,0	1	1	6.100	(1)
	825250126	C	250x125x250	250	14,8	125	7,4	460,0	425,0	300,0	1	1	13.030	(1)
	825250161	C	250x160x250			160	9,5	460,0	425,0	300,0	1	1	19.500	(1)
	825315126	C	315x125x315	315	18,7	125	7,4	480,0	457,5	300,0	1	1	25.000	(1)
	825315161	C	315x160x315			160	9,5	480,0	457,5	300,0	1	1	26.850	(1)
	825355126	C	355x125x355	355	21,1	125	7,4	480,0	507,5	330,0	1	1	32.500	(1)
	825355161	C	355x160x355			160	9,5	480,0	507,5	330,0	1	1	34.893	(1)
	825400126	C	400x125x400	400	23,7	125	7,4	480,0	560,0	360,0	1	1	42.100	(1)
	825400161	C	400x160x400			160	9,5	480,0	560,0	360,0	1	1	44.120	(1)

(*) Bajo demanda / (*) On request
(1) Bajo demanda. Consultar precio y disponibilidad. / (1) On request. Check availability and price.

TE REDUCIDA: TE SEGMENTADA - REDUCCIÓN

SEGMENTED TEE WITH
REDUCED

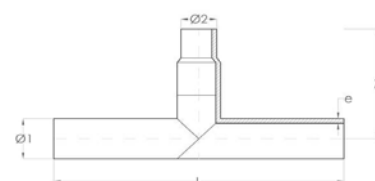

TIPO D / TYPE D

	código	*** TIPO	Ø	d1	e1	d2	e2	L	Z	H	uds.bolsa	uds.caja	peso (gr)	€/U
	code	*** TYPE	(mm)	(mm)	(mm)	(mm)	(mm)	(mm)	(mm)	(mm)	units bag	units box	weight (gr)	€/U
PP-R & PP-RP SDR11	*825315200	D	315x200x315	315	28,6	200	18,2	139,95	116,1	460,0	1	1	33.200	1.425,650
	*825315250	D	315x250x315			250	22,7	472,5	945,0	549,0	1	1	30.250	1.479,650

(*) Bajo demanda / (*) On request



TAPÓN END CAP

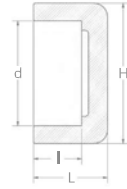

TIPO A / TYPE A

	código	TIPO	∅	d	H	l	L	uds.bolsa	uds.caja	peso (gr)	€/U
	code	TYPE	(mm)	(mm)	(mm)	(mm)	(mm)	units bag	units box	weight (gr)	€/U
SOLDADURA SOCKET	826001616	A	16	16	23	13	20,5	10	150	885	0,481
	826002020	A	20	20	29,5	14,5	23,5	10	150	980	0,478
	826002525	A	25	25	32	16	30,5	10	150	2.300	0,624
	826003232	A	32	32	44,5	18	32	10	80	2.390	1,172
	826004040	A	40	40	52	20,5	30	6	60	2.165	1,580
	826005050	A	50	50	65	23,5	34	3	36	2.247	3,541
	826006363	A	63	63	82	27,5	43	3	21	2.640	4,063
	826007575	A	75	75	98	30	52	2	12	2.601	7,101
	826009090	A	90	90	119	33	65	1	7	2.705	13,942
	826110110	A	110	110	144,5	37	63,5	1	5	2.710	21,944
	826125125	A	125	125	162,5	40	66	1	4	3.090	34,475
	826160160	A	160	160	198	43,2	81,5	1	1	1.260	79,094

TAPÓN SOLDADURA TOPE LARGO

LONG END CAP
BUTT WELDING

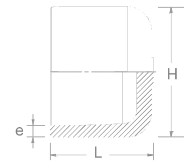

TIPO B / TYPE B

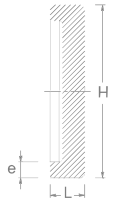

TIPO C / TYPE C

	código	TIPO	∅	H	e	L	uds.bolsa	uds.caja	peso (gr)	€/U
	code	TYPE	(mm)	(mm)	(mm)	(mm)	units bag	units box	weight (gr)	€/U
PP SDR11	826125125	B	160	160	14,60	70,0	1	1	818	34,475
	826B00200	B	200	200	18,20	80,0	1	1	1.070	226,053
	826B00250	B	250	250	22,70	90,0	1	1	1.989	331,199
	826B00315	B	315	315	28,70	70,0	1	1	6.200	445,240
	826B00355	C	* 355	355	67,50	65,0	1	1	7.400	889,000
	826B00400	C	* 400	400	70,00	60,0	1	1	8.500	1.091,000

(*) Tapón corto. Consultar su disponibilidad / (*) Short End Cap. Check availability.



ACCESORIOS MIXTOS PP-R

METAL JOINT
PP-R FITTINGS

CODO 90° ROSCA HEMBRA

FEMALE THREADED
90° ELBOW

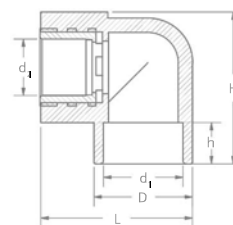

código	∅	d1	d2	D	h	H	L	uds.bolsa	uds.caja	peso (gr)	€/U
code	(mm)	(mm)	(pulg / in)	(mm)	(mm)	(mm)	(mm)	units bag	units box	weight (gr)	€/U
830021620	16x1/2"	16	1/2"	32,5	13	45,5	56	10	70	4.805	3,744
830022020	20x1/2"	20	1/2"	31	14,5	49,5	47	10	90	5.950	3,758
830022520	25x1/2"	25	1/2"	36	16	56	55,5	10	60	4.185	4,888
830022525	25x3/4"	25	3/4"	35,5	16	53,5	64,5	5	50	4.515	5,860
830023225	32x3/4"	32	3/4"	45,5	18	62,5	63	5	40	4.200	6,138
830023232	32x1"	32	1"	44	18	66,5	79,5	5	20	5.300	11,909

CODO 90° ROSCA MACHO

MALE THREADED
90° ELBOW

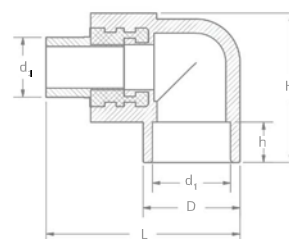

código	∅	d1	d2	D	h	H	L	uds.bolsa	uds.caja	peso (gr)	€/U
code	(mm)	(mm)	(pulg / in)	(mm)	(mm)	(mm)	(mm)	units bag	units box	weight (gr)	€/U
841011620	16x1/2"	16	1/2"	30,5	13	45	70,5	10	70	7.103	5,007
841012020	20x1/2"	20	1/2"	31	14,5	49	62	10	70	6.947	4,902
841012520	25x1/2"	25	1/2"	35,5	16	52,5	82,5	10	50	5.900	5,437
841012525	25x3/4"	25	3/4"	35,5	16	53	80	5	40	5.125	8,050
841013225	32x3/4"	32	3/4"	45,5	18	62	79	5	30	4.265	8,479
841013232	32x1"	32	1"	45,5	18	67	96	4	20	5.073	13,259

CODO 90° ROSCA HEMBRA PARED

FEMALE THREADED
WALL 90° ELBOW

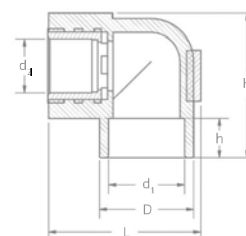

código	∅	d1	d2	D	h	H	L	uds.bolsa	uds.caja	peso (gr)	€/U
code	(mm)	(mm)	(pulg / in)	(mm)	(mm)	(mm)	(mm)	units bag	units box	weight (gr)	€/U
831021620	16x1/2"	16	1/2"	33	13	48	47	10	50	3.780	4,146
831022020	20x1/2"	20	1/2"	33	14,5	48	47	10	60	4.335	4,086
831022520	25x1/2"	25	1/2"	33,5	16	48,5	47,5	10	60	4.120	4,086



CODO 90° ROSCA MACHO PARED

MALE THREADED WALL 90° ELBOW

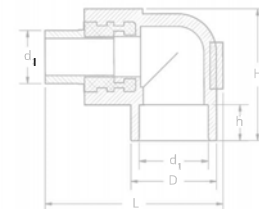

código code	Ø (mm)	d1 (mm)	d2 (pulg / in)	D (mm)	h (mm)	H (mm)	L (mm)	uds.bolsa units bag	uds.caja units box	peso (gr) weight (gr)	€/U €/U
832011620	16x1/2"	16	1/2"	33	13	48	68	10	50	5.626	5,413
832012020	20x1/2"	20	1/2"	33	14,5	48	67,5	10	50	5.302	5,334
832012520	25x1/2"	25	1/2"	33,5	16	48	68	10	50	5.105	5,334

TE ROSCA HEMBRA

FEMALE THREADED TEE



código code	Ø (mm)	d1 (mm)	d2 (pulg / in)	D (mm)	H (mm)	I (mm)	L (mm)	uds.bolsa units bag	uds.caja units box	peso (gr) weight (gr)	€/U €/U
829021620	16x1/2"x16	16	1/2"	30,5	51,5	13	53	10	60	5.368	4,335
829022020	20x1/2"x20	20	1/2"	30,5	51,5	14,5	53,5	10	70	4.955	4,459
829022520	25x1/2"x25	25	1/2"	35,5	53,5	16	67,5	10	50	3.700	5,296
829022525	25x3/4"x25	25	3/4"	35	56,5	16	63	10	40	3.741	6,316
829023225	32x3/4"x32	32	3/4"	42,5	67,5	18	74,5	5	25	2.990	7,053
829023232	32x1"x32	32	1"	45	77,5	18	74,5	4	20	2.973	12,275
829025025	50-3/4"-50	50	3/4"	65,5	75,5	23,5	95,5	2	12	2.340	11,986
829026325	63-3/4"-63	63	3/4"	82	102	27,5	115	2	6	2.073	18,973

TE ROSCA MACHO

MALE THREADED TEE

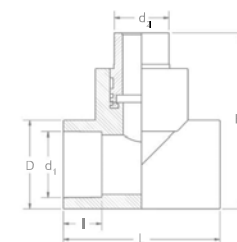

código code	Ø (mm)	d1 (mm)	d2 (pulg / in)	D (mm)	H (mm)	I (mm)	L (mm)	uds.bolsa units bag	uds.caja units box	peso (gr) weight (gr)	€/U €/U
840011620	16x1/2"x16	16	1/2"	30,5	66,5	13	53	10	60	6.070	5,355
840012020	20x1/2"x20	20	1/2"	31	66,5	14,5	52,5	10	60	6.241	5,274
840012520	25x1/2"x25	25	1/2"	35	72	16	63	10	40	4.821	6,484
840012525	25x3/4"x25	25	3/4"	35	73,5	16	62,5	10	40	5.653	7,491
840013225	32x3/4"x32	32	3/4"	44,5	84,5	18	74,5	5	20	4.053	8,813
840013232	32x1"x32	32	1"	45	94	18	74,5	4	16	4.421	13,842

MANGUITO ROSCA HEMBRA

FEMALE THREADED
COUPLING

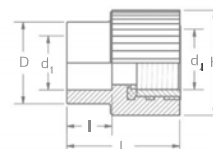

TIPO A / TYPE A

código	TIPO	∅	d1	d2	D	H	I	L	uds.bolsa	uds.caja	peso (gr)	€/U
code	TYPE	(mm)	(mm)	(pulg / in)	(mm)	(mm)	(mm)	(mm)	units bag	units box	weight (gr)	€/U
827021620	A	16x1/2"	16	1/2"	29	38	13	40,5	10	100	5.639	3,655
827022020	A	20x1/2"	20	1/2"	29	37,5	14,5	40	10	100	5.755	3,692
827022025	A	20x3/4"	20	3/4"	29	44	14,5	40,5	10	80	5.519	4,416
827022520	A	25x1/2"	25	1/2"	34,5	40	16	42	10	90	5.755	4,163
827022525	A	25x3/4"	25	3/4"	34,5	44,5	16	40,5	10	80	5.625	4,523

MANGUITO ROSCA HEMBRA

FEMALE THREADED
COUPLING

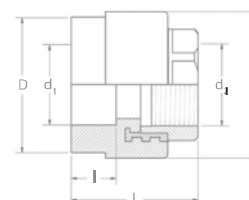

TIPO B / TYPE B

código	TIPO	∅	d1	d2	D	H	I	L	uds.bolsa	uds.caja	peso (gr)	€/U
code	TYPE	(mm)	(mm)	(pulg / in)	(mm)	(mm)	(mm)	(mm)	units bag	units box	weight (gr)	€/U
827023225	B	32x3/4"	32	3/4"	46	51,5	18	44,5	5	50	4.215	6,555
827023232	B	32x1"	32	1"	47,5	60,5	18	60,5	5	30	7.070	12,775
827024032	B	40x1"	40	1"	64,5	71	20,5	56,5	3	24	6.420	15,685
827024040	B	40x1 1/4"	40	1 1/4"	65	75	20,5	61,5	3	18	5.790	22,699

MANGUITO ROSCA HEMBRA

FEMALE THREADED
COUPLING

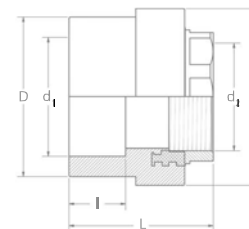

TIPO C / TYPE C

código	TIPO	∅	d1	d2	D	H	I	L	uds.bolsa	uds.caja	peso (gr)	€/U
code	TYPE	(mm)	(mm)	(pulg / in)	(mm)	(mm)	(mm)	(mm)	units bag	units box	weight (gr)	€/U
827025050	C	50x1 1/2"	50	1 1/2"	68	80,5	23,5	66,5	3	15	6.060	26,439
827026363	C	63x2"	63	2"	83,5	92,5	27,5	77,5	2	8	4.040	31,984
827027575	C	75x2 1/2"	75	2 1/2"	98	119,5	30	79,5	1	6	5.045	55,587
827029090	C	90 - 3"	90	3"	119	143	33	102,5	1	3	4.970	104,180
827020110	C	110-4"	110	4"	154	157,5	37	119	1	3	6.072	133,782



MANGUITO ROSCA MACHO

MALE THREADED
COUPLING

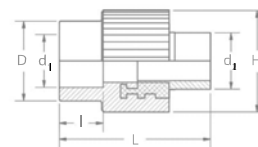

TIPO A / TYPE A

código	TIPO	∅	d1	d2	D	H	I	L	uds.bolsa	uds.caja	peso (gr)	€/U
code	TYPE	(mm)	(mm)	(pulg / in)	(mm)	(mm)	(mm)	(mm)	units bag	units box	weight (gr)	€/U
828011620	A	16x1/2"	16	1/2"	29	37,5	13	54,5	10	90	7.993	4,708
828012020	A	20x1/2"	20	1/2"	29	37,5	14,5	55	10	90	6.263	4,856
828012025	A	20x3/4"	20	3/4"	29	39	14,5	57	10	80	8.956	6,323
828012520	A	25x1/2"	25	1/2"	34,5	40	16	56,5	10	80	6.060	5,430
828012525	A	25x3/4"	25	3/4"	34,5	38,5	16	57	10	80	7.930	7,723

MANGUITO ROSCA MACHO

MALE THREADED
COUPLING

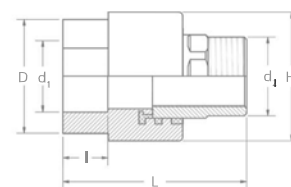

TIPO B / TYPE B

código	TIPO	∅	d1	d2	D	H	I	L	uds.bolsa	uds.caja	peso (gr)	€/U
code	TYPE	(mm)	(mm)	(pulg / in)	(mm)	(mm)	(mm)	(mm)	units bag	units box	weight (gr)	€/U
828013225	B	32x3/4"	32	3/4"	46	51,5	18	62	5	40	5.373	7,981
828013232	B	32x1"	32	1"	47,5	59,5	18	77,5	5	30	6.100	13,831
828014032	B	40x1"	40	1"	65	70,5	20,5	74,5	3	18	4.731	17,295
828014040	B	40x1 1/4"	40	1 1/4"	65	75	20,5	83	3	18	7.420	26,078

MANGUITO ROSCA MACHO

MALE THREADED
COUPLING

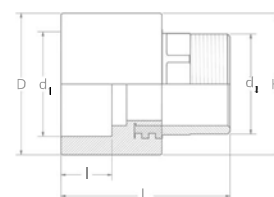

TIPO C / TYPE C

código	TIPO	∅	d1	d2	D	H	I	L	uds.bolsa	uds.caja	peso (gr)	€/U
code	TYPE	(mm)	(mm)	(pulg / in)	(mm)	(mm)	(mm)	(mm)	units bag	units box	weight (gr)	€/U
828015050	C	50x1 1/2"	50	1 1/2"	68	75,5	23,5	89	2	12	6.485	34,646
828016363	C	63x2"	63	2"	83,5	84,5	27,5	100	2	10	5.780	41,994
828017575	C	75x2 1/2"	75	2 1/2"	98	99,5	30	105	1	6	5.245	71,853
828019090	C	90 - 3"	90	3"	119	121,5	33	129,5	1	3	4.650	134,011
828010110	C	110-4"	110	4"	154	156,5	37	159	1	2	6.300	199,138



ENLACE RECTO TUERCA LOCA HEMBRA

ADAPTOR WITH
FREE NUT

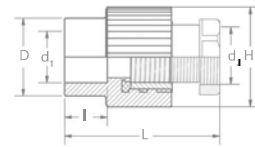

TIPO A / TYPE A

código	TIPO	∅	d1	d2	D	H	I	L	uds.bolsa	uds.caja	peso (gr)	€/U
code	TYPE	(mm)	(mm)	(pulg / in)	(mm)	(mm)	(mm)	(mm)	units bag	units box	weight (gr)	€/U
827032025	A	20 - 3/4"	20	3/4"	29	37,5	14,5	54	10	80	9.855	8,754
827032525	A	25 - 3/4"	25	3/4"	34,5	40	16	55,5	10	60	7.750	9,295
827032032	A	20 - 1"	20	1"	30	44	14,5	58,5	10	60	10.953	13,549
827032532	A	25 - 1"	25	1"	34,5	44,5	16	57	10	40	7.170	13,672

ENLACE RECTO TUERCA LOCA HEMBRA

ADAPTOR WITH
FREE NUT

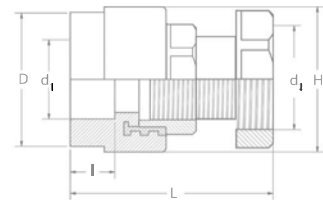

TIPO B / TYPE B

código	TIPO	∅	d1	d2	D	H	I	L	uds.bolsa	uds.caja	peso (gr)	€/U
code	TYPE	(mm)	(mm)	(pulg / in)	(mm)	(mm)	(mm)	(mm)	units bag	units box	weight (gr)	€/U
827033232	B	32 - 1"	32	1"	46	51	18	64	5	30	5.725	16,009
827033240	B	32 - 1 1/4"	32	1 1/4"	47,5	60,5	18	84	5	20	9.000	25,760
827034040	B	40 - 1 1/4"	40	1 1/4"	65	71	20,5	75	5	15	8.500	30,566

CONECTOR UNIVERSAL

UNIVERSAL ADAPTER

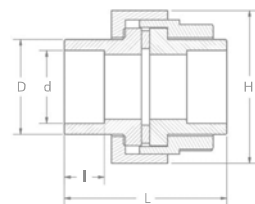

código	∅	d	D	H	I	L	uds.caja	peso (gr)	€/U
code	(mm)	(mm)	(mm)	(mm)	(mm)	(mm)	units box	weight (gr)	€/U
846000020	20	20	27,5	50	14,5	62,5	25	4.835	24,631
846000025	25	25	36	54	16	68,5	25	8.013	28,031
846000032	32	32	41,5	68	18	69,5	20	10.093	38,992
846000040	40	40	53	86	20,5	73,5	12	9.945	65,231
846000050	50	50	58	96	23,5	78	8	7.800	81,305
846000063	63	63	73	116	27,5	87	5	7.848	127,175
846000075	75	75	88	138	30	94	4	8.517	175,442
846000090	90	90	109	175	33	101	2	6.295	325,229
846000110	110	110	130	202	37	108	2	8.099	402,516



CONECTOR ROSCA MACHO

MALE THREADED
ADAPTER

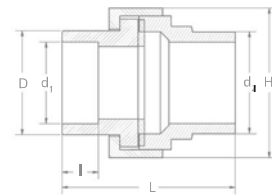

código	Ø	d1	d2	D	H	I	L	uds.caja	peso (gr)	€/U
code	(mm)	(mm)	(pulg / in)	(mm)	(mm)	(mm)	(mm)	units box	weight (gr)	€/U
847100020	20 x 1/2	20	1/2"	27,5	37,5	14,5	53	40	5.825	24,120
847300020	20 - 3/4'	20	3/4"	28,1	45,9	14,7	70	40	6.150	25,119
847100025	25 x 3/4	25	3/4"	36	48	16	60	30	7.250	26,609
847300025	25 - 1'	25	1"	33,9	50,8	20,4	75,3	30	9.339	27,107
847100032	32 x 1	32	1"	41,5	54	18	65	20	5.865	39,263
847300032	32 - 1 1/4'	32	1 1/4"	39,7	64,9	17,7	81,5	20	10.158	43,575
847100040	40 x 1 1/4	40	1 1/4"	53	67	20,5	71	12	6.350	64,405
847300040	40 - 1 1/2'	40	1 1/2"	49,2	80	19,8	84,7	12	8.487	72,067
847100050	50 x 1 1/2	50	1 1/2"	58	76	23,5	85,5	8	7.942	93,396
847300050	50 - 2'	50	2"	58,9	89,9	21,8	92,5	8	8.676	95,315
847100063	63 x 2	63	2"	73	92,5	27,5	96	6	6.385	136,913
847300063	63 - 2 1/2'	63	2 1/2"	73,9	109,9	26,2	96,5	6	10.131	155,834
847100075	75 x 2 1/2	75	2 1/2"	88	90	30	138	4	9.773	219,453

CONECTOR ROSCA HEMBRA

FEMALE
THREADED ADAPTER

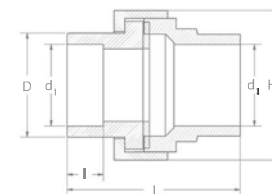

código	Ø	d1	d2	D	H	I	L	uds.caja	peso (gr)	€/U
code	(mm)	(mm)	(pulg / in)	(mm)	(mm)	(mm)	(mm)	units box	weight (gr)	€/U
847200020	20 - 1/2	20	1/2"	27,5	50	14,5	55	40	11.069	24,120
847200025	25 - 3/4	25	3/4"	36	54	16	58	30	9.182	26,609
847000025	25 - 1	25	1"	36	54	16	66,64	30	9.033	26,438
847200032	32 - 1	32	1"	41,5	68	18	57,5	20	10.885	39,263
847000032	* 32 - 1 1/4	32	1 1/4"	41,5	68	18	68	20	10.573	35,074
847200040	40 - 1 1/4	40	1 1/4"	53	86	20,5	60	12	9.159	64,405
847000040	* 40 - 1 1/2	40	1 1/2"	53	86	20,5	72	12	9.441	62,534
847200050	50 - 1 1/2	50	1 1/2"	58	96	23,5	71	8	8.550	93,396
847200063	63 - 2	63	2"	73	116	27,5	75,07	6	7.827	121,031
847000063	* 63 - 2 1/2	63	2 1/2"	73	116	27,5	79,5	6	9.321	112,573
847200075	75 - 2 1/2	75	2 1/2"	88	138	30	79	4	9.453	167,475
847000075	* 75 - 3	75	3"	88	138	30	84	4	8.653	167,251

(*) Disponibles hasta fin de existencias / (*) Available while stocks last

CUELLO BRIDA CON JUNTA

STUB FLANGE WITH FLAT RING

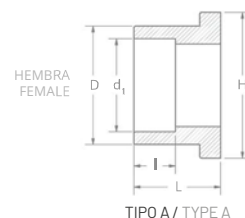

	código	TIPO	∅	d1	D	H	L	I1	uds.bolsa	uds.caja	peso (gr)	€/U
	code	TYPE	(mm)	(mm)	(mm)	(mm)	(mm)	(mm)	units bag	units box	weight (gr)	€/U
SOLDADURA SOCKET	849100020	A	20	20	28	33,5	30	14,5	10	150	2.415	2,997
	849100025	A	25	25	34	39	33	16	10	100	2.085	3,249
	849100032	A	32	32	40,5	50	33	18	10	70	2.020	3,281
	849100040	A	40	40	49,5	60	35,5	20,5	6	42	1.895	4,644
	849100050	A	50	50	59	71,5	37,5	23,5	4	24	1.532	7,435
	849100063	A	63	63	76,2	102,3	41,8	27,7	2	20	2.255	10,180
	849100075	A	75	75	89,1	121,9	45,9	30,4	2	12	1.850	11,053
	849100090	A	90	90	109	137	49,5	33	1	7	2.010	20,182
	849100110	A	110	110	130	156	52,5	37	1	5	1.805	27,029
	849100125	A	125	125	163	186,5	65	40	1	2	6.541	53,540

CUELLO BRIDA SOLDADURA TOPE LARGO

LONG STUB FLANGE FOR BUTT FUSION

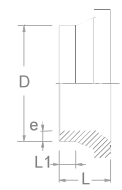
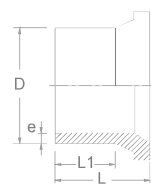

	código	TIPO	∅	D	e	L	L1	uds.bolsa	uds.caja	peso (gr)	€/U
	code	TYPE	(mm)	(mm)	(mm)	(mm)	(mm)	units bag	units box	weight (gr)	€/U
PP SDR11	849150162	B	160	160	14,5	180,1	104,6	1	1	955	150,193
	849150200	B	200	200	19,9	187,7	114,5	1	1	1.957	223,179
	849150250	B	250	250	25,5	208,1	132,1	1	1	2.717	282,593
	849150315	B	315	315	28,60	204,9	135,9	1	1	5.650	673,043
	849150355	C*	355	355	32,20	470,0	320,0	1	1	9.000	475,360
	849150400	C*	400	400	36,30	474,7	319,8	1	1	12.000	868,260

* Cuello Brida Corto PPH SDR 11 / * Short Flange Neck PPH SDR11



VALVULAS PP-R
PP-R VALVES

LLAVE CON EMBELLECEDOR

STOPCOCK EMBELLISHED

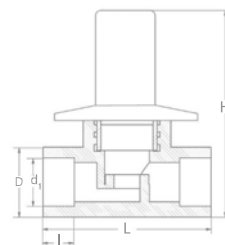

código	∅	d1	D	H	l	L	uds.bolsa	uds.caja	peso (gr)	€/U
code	(mm)	(mm)	(mm)	(mm)	(mm)	(mm)	units bag	units box	weight (gr)	€/U
836002020	20x3/4"	20	29,5	93	14,5	74	6	18	5.630	22,281
836002525	25x3/4"	25	35	97,5	16	83	6	18	6.040	22,796
836003232	32x1"	32	42,5	103	18	97,5	5	10	4.583	30,500

CUERPO LLAVE

STOPCOCK BODY

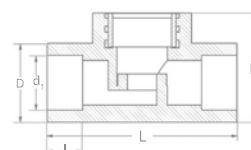

código	∅	d1	D	H	l	L	uds.bolsa	uds.caja	peso (gr)	€/U
code	(mm)	(mm)	(mm)	(mm)	(mm)	(mm)	units bag	units box	weight (gr)	€/U
837002034	20x3/4"	20	29,5	45,5	14,5	74	6	42	3.935	6,173
837002534	25x3/4"	25	35	49	16	83	6	36	3.931	6,894
837003232	32x1"	32	42,5	54,5	18	97,5	5	20	3.000	9,743

MOLDURA LLAVE EMBELLECEDOR

STOPCOCK MOULDING



código	∅	uds.bolsa	uds.caja	peso (gr)	€/U
code	(mm)	units bag	units box	weight (gr)	€/U
838003434	3/4"	1	100	9.500	7,950
838003232	1"	1	100	16.713	10,552

EMBELLECEDOR LLAVE

STOPCOCK EMBELLISHER



código	∅	uds.bolsa	uds.caja	peso (gr)	€/U
code		units bag	units box	weight (gr)	€/U
839003434	20-25-32 (3/4" - 1")	1	40	4.655	9,468



LLAVE EMBELLECEDOR ASTA LARGA

STOPCOCK EMBELLISHED
WITH LONG HANDLE

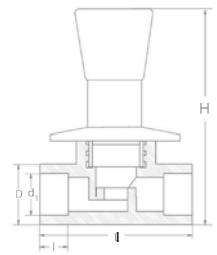

código	∅	d1	D	H	I	L	uds.bolsa	uds.caja	peso (gr)	€/U
code	(mm)	(mm)	(mm)	(mm)	(mm)	(mm)	units bag	units box	weight (gr)	€/U
836500020	20x3/4"	20	29,5	116	14,5	74	6	12	5.625	27,122
836500025	25x3/4"	25	35	119,5	16	83	6	12	5.810	27,122
836500032	32x1"	32	42,5	132,5	18	97,5	5	10	5.775	31,356

MOLDURA LLAVE EMBELLECEDOR ASTA LARGA

STOPCOCK MOULDING
LONG HANDLE



código	∅	uds.bolsa	uds.caja	peso (gr)	€/U
code	(mm)	units bag	units box	weight (gr)	€/U
838500234	3/4"	1	100	12.213	6,754
838500232	1"	1	100	18.313	12,175

EMBELLECEDOR LLAVE ASTA LARGA

STOPCOCK EMBELLISHER
WITH LONG HANDLE



código	∅	uds.bolsa	uds.caja	peso (gr)	€/U
code	(mm)	units bag	units box	weight (gr)	€/U
839022532	20-25-32 (3/4" - 1")	1	30	7.430	14,354

PROLONGADOR LLAVE ASTA LARGA

STOPCOCK EMBELLISHER
EXTENSION



código	∅	uds.bolsa	uds.caja	peso (gr)	€/U
code	(mm)	units bag	units box	weight (gr)	€/U
840000234	20-25-32 (3/4" - 1")	1	150	9.783	7,188

LLAVE CIERRE LATÓN

BRASS STOPCOCK

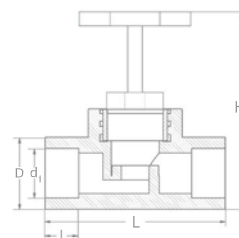

código	Ø (mm)	d1 (mm)	D (mm)	H (mm)	l (mm)	L (mm)	uds.bolsa	uds.caja	peso (gr)	€/U
code	(mm)	(mm)	(mm)	(mm)	(mm)	(mm)	units bag	units box	weight (gr)	€/U
836202034	20x3/4"	20	29,5	114,5	14,5	74	6	18	3.705	15,383
836202534	25x3/4"	25	35	118	16	83	6	18	3.975	15,613
836203232	32x1"	32	42,5	130,5	18	97,5	5	10	4.273	23,889
836204040	40x1 1/4"	40	49,5	115	20,5	115	5	6	5.291	65,077

KIT MOLDURA LLAVE CIERRE LATÓN

KIT BRASS MOULDING SHORT STOPCOCK



código	Ø (mm)	uds.caja	peso (gr)	€/U
code	(mm)	units box	weight (gr)	€/U
838110025	3/4"	50	5.780	9,465
838110032	1"	40	6.510	15,282

LLAVE INCLINADA

ANGLED STOPCOCK

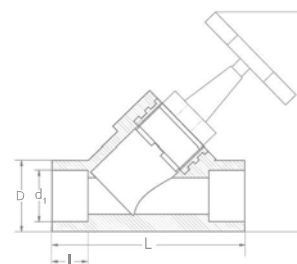

código	Ø (mm)	d1 (mm)	D (mm)	H (mm)	l (mm)	L (mm)	uds.bolsa	uds.caja	peso (gr)	€/U
code	(mm)	(mm)	(mm)	(mm)	(mm)	(mm)	units bag	units box	weight (gr)	€/U
836102034	20x3/4"	20	34	119	14,5	89,2	10	20	6.620	18,823
836102534	25x3/4"	25	34	119	16	89,2	10	20	6.510	18,823
836103232	32x1"	32	43	134	18	111,7	5	10	4.493	28,654

CUERPO LLAVE INCLINADA

ANGLED STOPCOCK BODY



código	Ø (mm)	d1 (mm)	D (mm)	H (mm)	l (mm)	L (mm)	uds.bolsa	uds.caja	peso (gr)	€/U
code	(mm)	(mm)	(mm)	(mm)	(mm)	(mm)	units bag	units box	weight (gr)	€/U
837102034	20x3/4"	20	34	66	14,5	89,2	10	30	3.741	9,213
837102534	25x3/4"	25	34	66	16	89,2	10	30	3.568	9,543
837103232	32x1"	32	43	80	18	111,7	6	18	3.129	19,089



LLAVE BOLA DESMONTABLE C/CUELLO BRIDA

REMOVABLE VALVE BALL WITH STUB FLANGE

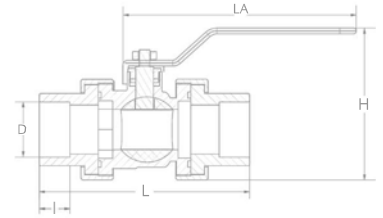

código	∅	D	H	I	L	LA	uds.caja	peso (gr)	€/U
code	(mm)	(mm)	(mm)	(mm)	(mm)	(mm)	units box	weight (gr)	€/U
836420020	20	20	69,5	14,5	101	101,5	30	9.760	16,576
836420025	25	25	78,5	16	111,5	103	20	9.940	23,227
836420032	32	32	89,5	18	120	121	10	7.235	33,679
836420040	40	40	106	20,5	138	151,5	8	6.915	55,816
836420050	50	50	125,5	23,5	148,5	162	6	10.665	90,352
836420063	63	63	150,5	27,5	164	165,5	3	8.847	142,533

VÁLVULA BOLA LLAVE LATÓN

STOPCOCK VALVE BRASS BALL

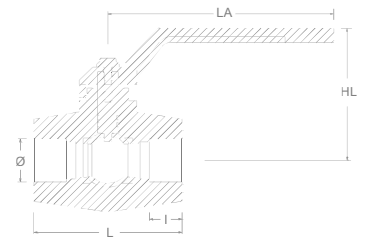

código	∅	HL	I	L	LA	uds.bolsa	uds.caja	peso (gr)	€/U
code	(mm)	(mm)	(mm)	(mm)	(mm)	units bag	units box	weight (gr)	€/U
836400020	20	60	14,5	67,5	102	1	30	2.925	12,298
836400025	25	60	16	70,5	102	1	25	1.795	16,387
836400032	32	64	18	79,5	102	1	16	2.933	21,844
836400040	40	78	20,5	94	120	1	8	3.005	54,561
836400050	50	83	23,5	109	120	1	6	3.381	78,265
836400063	63	103	27,5	130	146	1	3	3.700	125,117
836400075	75	110	30	151	146	1	2	3.053	216,121
836400090	90	127	33	185	248	1	2	4.741	291,911
836400110	110	135	37	213	248	1	2	6.641	446,855
836400125	125	160	50	240	305	1	2	7.750	812,317

VÁLVULA BOLA LLAVE LATÓN

STOPCOCK VALVE BRASS BALL

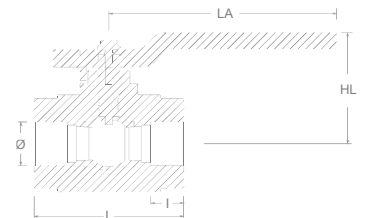

código	∅	HL	I	L	LA	uds.bolsa	uds.caja	peso (gr)	€/U
code	(mm)	(mm)	(mm)	(mm)	(mm)	units bag	units box	weight (gr)	€/U
836700020	20	20	54	83	14,5	102	1	167	115,260
836700025	25	25	64,5	98	16	115,5	1	239	136,077
836700032	32	32	73	108	18,1	128	1	308	168,039
836700040	40	40	85	127,5	20,5	144,5	1	475	208,220
836700050	50	50	97	139,5	23,5	165,5	1	657	269,531
836700063	63	63	120	168,5	27,4	198	1	1.137	336,072

VALVULA BOLA PP-H CON CUELLO BRIDA CON SEGURO

STOPCOCK PP-H VALVE
WITH ASSURANCE

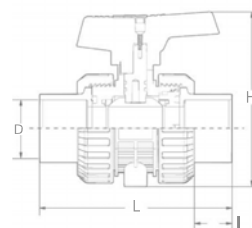

código code	∅ (mm)	d (mm)	D (mm)	H (mm)	I (mm)	L (mm)	uds.caja units box	peso (gr) weight (gr)	€/U €/U
836700020	20	20	54	83	14,5	102	1	167	115,260
836700025	25	25	64,5	98	16	115,5	1	239	136,077
836700032	32	32	73	108	18,1	128	1	308	168,039
836700040	40	40	85	127,5	20,5	144,5	1	475	208,220
836700050	50	50	97	139,5	23,5	165,5	1	657	269,531
836700063	63	63	120	168,5	27,4	198	1	1.137	336,072

VÁLVULA DE MARIPOSA EMBRIDADA CON MANETA PP

FLANGED BUTTERFLY VALVE
WITH PP HANDLE



DN80 - DN200 (PN10)



DN250 (PN6)

código code	∅ (mm)	DN (mm)	PN (bar)	uds.caja units box	€/U €/U
750301090	90	80	10	1	629,550
750301110	110	100	10	1	739,550
750301125	125 - 140	125	10	1	889,550
750301160	160	150	10	1	995,070
750301200	200 - 225	200	10	1	1.414,360
* 750301251	250	250	6	1	3.895,000

(*) Presión de trabajo SDR17 / (*) Working pressure SDR17



DERIVACIONES PP-R
PP-R SADDLE ADAPTATORS



DERIVACIÓN SOLDABLE SALIDA HEMBRA

FEMALE SADDLE
ADAPTOR

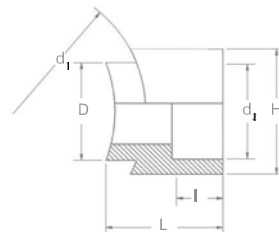

código	Ø	d1	d2	D	H	I	L	uds.bolsa	uds.caja	peso (gr)	€/U
code	(mm)	(mm)	(mm)	(mm)	(mm)	(mm)	(mm)	units bag	units box	weight (gr)	€/U
840004020	40-20	40	20	20-25	37,50	14,5	40,50	5	75	1.500	2,259
840005020	50-20	50	20	20-25	37,5	14,5	36,00	5	75	1.316	2,259
840006320	63-20	63	20	20-25	38,00	14,5	37,50	5	75	1.337	2,259
840007520	75-20	75	20	20-25	37,50	14,5	38,00	5	75	1.371	2,259
840009020	90-20	90	20	20-25	37,50	14,5	40,00	5	75	1.383	2,259
840011020	110-20	110	20	20-25	38,50	14,5	40,50	5	75	1.347	2,259
840112520	125-20	125	20	20-25	38,00	14,5	43,00	5	50	1.024	2,259
840116020	160-20	160-400	20	20-25	38,00	14,5	46,00	5	70	1.367	2,259
840004025	40-25	40	25	20-25	38,00	16	41,50	5	75	1.550	2,609
840005025	50-25	50	25	20-25	38,00	16	37,50	5	75	1.482	2,609
840006325	63-25	63	25	20-25	38,50	16	38,00	5	75	1.520	2,609
840007525	75-25	75	25	20-25	37,50	16	40,00	5	75	1.493	2,609
840009025	90-25	90	25	20-25	38,00	16	40,50	5	60	1.290	2,609
840011025	110-25	110	25	20-25	39,00	16	41,00	5	45	950	2,609
840112525	125-25	125	25	20-25	37,50	16	44,00	5	50	1.094	2,609
840116025	160-25	160-400	25	20-25	38,00	16	47,00	5	70	1.515	2,609
840005032	50-32	50	32	32	42,50	18	43,00	5	75	2.158	3,488
840006332	63-32	63	32	32	42,50	18	42,50	5	75	2.090	3,488
840007532	75-32	75	32	32	42,50	18	41,50	5	60	1.690	3,488
840009032	90-32	90	32	32	42,50	18	43,00	5	45	1.375	3,488
840011032	110-32	110	32	32	42,50	18	44,00	5	45	1.375	3,488
840112532	125-32	125	32	32	42,50	18	48,00	5	45	1.420	3,488
840116032	160-32	160-400	32	32	42,50	18	50,00	5	70	2.149	3,488
840007540	75-40	75	40	40	51,50	20,5	47,00	5	45	2.660	4,592
840009040	90-40	90	40	40	51,50	20,5	46,50	5	35	1.680	4,592
840011040	110-40	110	40	40	51,50	20,5	48,00	5	35	1.755	4,592
840112540	125-40	125	40	40	51,50	20,5	52,50	5	40	1.995	4,592
840116040	160-40	160-400	40	40	51,50	20,5	54,00	5	40	2.026	4,592
840011050	110-50	110	50	50	68,00	23,5	51,50	5	25	2.204	5,180
840112550	125-50	125	50	50	67,50	23,5	53,00	3	27	2.320	5,180
840116050	160-50	160-400	50	50	68,00	23,5	54,50	5	20	1.790	5,180
840011063	110-63	110	63	63	83,50	27,5	60,00	6	12	1.707	8,785
840112563	125-63	125	63	63	82,00	27,5	60,50	6	15	2.208	8,785
840116063	160-63	160-400	63	63	82,00	27,5	61,00	4	16	2.245	8,785

(*) Consultar cantidad / (*) Check quantity



DERIVACIÓN SOLDABLE SALIDA MACHO

MALE SADDLE
ADAPTOR

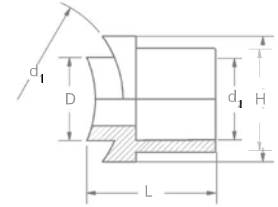

código	∅	d1	* d2	D (taladro)	H	L	uds.caja	peso (gr)	€/U
code	(mm)	(mm)	(mm)	(mm)	(mm)	(mm)	units box	weight (gr)	€/U
841009063	90-63	90	63	50,0	67,5	63,5	12	1.361	16,201
841011063	110-63	110	63	50,0	67,0	87,0	12	1.400	16,201
841012563	125-63	125	63	50,0	67,0	80,0	12	1.400	15,805
841016063	160-63	160	63	50,0	67,0	82,0	12	1.400	15,805
841020063	200-63	200	63	50,0	67,0	86,0	12	1.400	15,805
841025063	250-63	250	63	50,0	68,5	90,0	12	1.410	15,805
841031563	315-63	315	63	50,0	68,0	96,0	12	1.469	16,255
841040063	400-63	400	63	50,0	68,0	97,0	12	1.471	15,859
841009075	90-75	90	75	63	82,1	96	10	1.835	19,382
841011075	110-75	110	75	63,0	82,0	95,0	12	2.000	19,382
841012575	125-75	125	75	63,0	82,0	90,0	10	1.830	18,909
841016075	160-75	160	75	63,0	82,0	95,0	12	2.000	18,909
841020075	200-75	200	75	63,0	82,0	92,0	12	2.000	18,909
841025075	250-75	250	75	63,0	83,0	95,0	12	2.084	18,909
841031575	315-75	315	75	63,0	83,5	100,5	12	2.156	18,965
841040075	400-75	400	75	63,0	83,5	100,5	12	2.168	18,965
841011090	110-90	110	90	75	101,6	111,1	8	2.146	22,962
841012590	125-90	125	90	75,0	101,5	111,5	8	2.292	22,911
841016090	160-90	160	90	75,0	101,0	103,5	8	2.188	22,911
841020090	200-90	200	90	75,0	101,5	105,0	8	2.196	22,911
841025090	250-90	250	90	75,0	101,0	108,5	8	2.204	22,401
841031590	315-90	315	90	75,0	101,0	112,5	8	2.252	22,401
841016011	160-110	160	110	87,0	120,0	113,0	3	1.530	40,538
841020011	200-110	200	110	87,0	120,0	113,0	3	1.515	40,538
841025011	250-110	250	110	87,0	121,0	118,5	3	1.535	40,538
841031511	315-110	315	110	87,0	121,0	121,5	3	1.530	41,551
841040011	400-110	400	110	87,0	121,5	121,5	3	1.522	40,538

(*) En matriz soldasientos seleccionar un diámetro (D) menor que el diámetro (d2) de la derivación macho.
 (*) In a saddle dies select a diameter (D) smaller than the diameter (d2) of the male saddle adaptor.

DERIVACIÓN SOLDABLE SALIDA ROSCA HEMBRA

FEMALE THREADED
SADDLE ADAPTOR

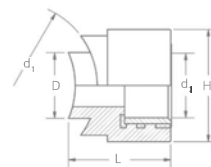

código code	Ø (mm)	d1 (mm)	d2 (pulg / in)	D (mm)	H (mm)	L (mm)	uds.bolsa	uds.caja	peso (gr)	€/U
							units bag	units box	weight (gr)	€/U
845104012	40 x 1/2"	40	1/2"	20 - 25	37,50	42,00	5	75	4.075	6,181
845105012	50 x 1/2"	50	1/2"	20 - 25	38,00	37,50	5	75	4.030	6,181
845106312	63 x 1/2"	63	1/2"	20 - 25	38,00	39,00	5	75	3.989	6,181
845107512	75 x 1/2"	75	1/2"	20 - 25	38,50	39,50	5	75	4.120	6,181
845109012	90 x 1/2"	90	1/2"	20 - 25	38,00	40,50	5	75	4.080	6,181
845111012	110 x 1/2"	110	1/2"	20 - 25	38,00	42,00	5	75	4.055	6,181
845112512	125 x 1/2"	125	1/2"	20 - 25	38,00	43,50	5	45	2.506	6,181
845116012	160 x 1/2"	160-400	1/2"	20 - 25	38,00	47,50	5	70	3.885	6,181
845104034	40 x 3/4"	40	3/4"	20 - 25	43,00	41,50	5	75	5.265	7,904
845105034	50 x 3/4"	50	3/4"	20 - 25	42,50	37,50	5	65	4.620	7,904
845106334	63 x 3/4"	63	3/4"	20 - 25	43,00	38,50	5	65	4.575	7,904
845107534	75 x 3/4"	75	3/4"	20 - 25	43,00	40,00	5	65	4.514	7,904
845109034	90 x 3/4"	90	3/4"	20 - 25	43,00	40,50	5	45	3.275	7,904
845111034	110 x 3/4"	110	3/4"	20 - 25	43,00	41,50	5	45	3.244	7,904
845112534	125 x 3/4"	125	3/4"	20 - 25	43,00	43,50	5	45	3.232	7,904
845116034	160 x 3/4"	160-400	3/4"	20 - 25	42,50	47,00	5	70	5.060	7,904
845107532	75 x 1"	75	1"	40	57,00	51,00	5	40	9.210	15,549
845109032	90 x 1"	90	1"	40	57,00	52,00	5	35	6.536	15,549
845111032	110 x 1"	110	1"	40	57,00	52,00	5	35	7.703	15,549
845112532	125 x 1"	125	1"	40	57,00	56,00	5	35	7.985	15,549
845116032	160 x 1"	160-400	1"	40	57,00	57,50	5	30	6.870	15,549

DERIVACIÓN SOLDABLE SALIDA ROSCA MACHO

MALE THREADED
SADDLE ADAPTOR

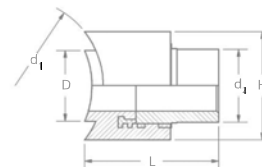

código code	Ø (mm)	d1 (mm)	d2 (mm)	D (taladro) (mm)	H (mm)	L (mm)	uds.bolsa	uds.caja	peso (gr)	€/U
							units bag	units box	weight (gr)	€/U
845205012	50 x 1/2"	50	1/2"	20 - 25	36,00	59,50	5	75	7.985	10,150
845206312	63 x 1/2"	63	1/2"	20 - 25	36,00	59,50	5	75	7.925	10,150
845207512	75 x 1/2"	75	1/2"	20 - 25	36,00	59,50	5	75	7.900	10,150
845209012	90 x 1/2"	90	1/2"	20 - 25	36,00	59,50	5	75	8.041	10,150
845205034	50 x 3/4"	50	3/4"	20 - 25	39,00	59,50	5	75	10.355	12,891
845207534	75 x 3/4"	75	3/4"	20 - 25	39,00	59,50	5	75	10.380	12,891
845209034	90 x 3/4"	90	3/4"	20 - 25	39,00	59,50	5	75	10.260	12,891



INSERTO CON PLETINA

INSERT WITH PLATTEN

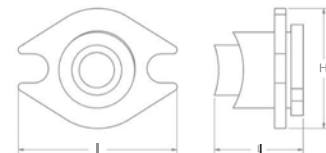

código	∅	H	I	L	uds.bolsa	uds.caja	peso (gr)	€/U
code	(mm)	(mm)	mm	(mm)	units bag	units box	weight (gr)	€/U
845000020	25	60,00	80,00	43,00	10	60	7.264	6,178

INSERTO

INSERT

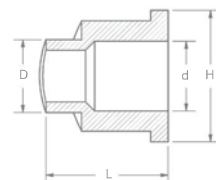

código	∅	D (taladro)	d	H	L	uds.bolsa	uds.caja	peso (gr)	€/U
code	(mm)	(mm)	(mm)	(mm)	(mm)	units bag	units box	weight (gr)	€/U
845000200	25	25	24,00	45,00	43,00	20	60	1.577	2,033

PLETINA PARA BATERIAS

MANIFOLD PLATTEN



código	∅	L	H	I	D	uds.bolsa	uds.caja	peso (gr)	€/U
code	(mm)	(mm)	(mm)	(mm)	(mm)	units bag	units box	weight (gr)	€/U
849006375	25	80,00	60,00	6,00	38,00	10	60	5.900	4,085

INSERTO CON ROSCA HEMBRA

INSERT WITH FEMALE THREADED SADDLE

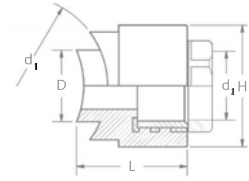

código	∅	d1	d2	D	H	L	uds.bolsa	uds.caja	peso (gr)	€/U
code	(mm)	(mm)	(pulg / in)	(mm)	(mm)	(mm)	units bag	units box	weight (gr)	€/U
845007534	63-75 x 3/4"	63 - 75	3/4"	20 - 25	44,00	52,00	10	60	6.748	7,145

DERIVACIÓN CURVA

CURVE DERIVATION

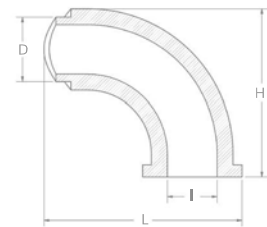

código	∅	D (taladro)	I	H	L	uds.bolsa	uds.caja	peso (gr)	€/U
code	(mm)	(mm)	(mm)	(mm)	(mm)	units bag	units box	weight (gr)	€/U
845206375	50-63/75	20 - 25	21	85	101,5	5	30	2.490	5,516
845290110	90-110	20 - 25	21	83,8	104	5	30	2.485	5,516

SALVATUBOS

CROSSOVER

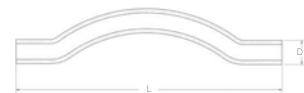

código	∅	D	L	uds.caja	peso (gr)	€/U
code	(mm)	(mm)	(mm)	units box	weight (gr)	€/U
835001616	16	16	280,00	50	1.813	1,678
835002020	20	20	280,00	40	2.150	1,913
835002525	25	25	280,00	30	2.395	2,452
835003232	32	32	280,00	16	2.101	3,415



TAPÓN DE REPARACIÓN

REPAIR CAP

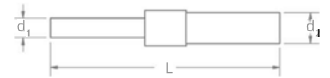

código	∅	d1	d2	L	uds.bolsa	uds.caja	peso (gr)	€/U
code	(mm)	(mm)	(mm)	(mm)	units bag	units box	weight (gr)	€/U
843000711	7x11	7	11	83	100	200	1.363	1,026

COLECTOR

COLLECTOR

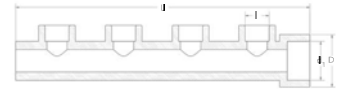

código	∅	d1	D	l	L	uds.bolsa	uds.caja	peso (gr)	€/U
code	(mm)	(mm)	(mm)	(mm)	(mm)	units bag	units box	weight (gr)	€/U
840043216	32 - 16	32	43,5	16	243,5	5	15	2.343	7,263
840043220	32 - 20	32	43,5	20	243,5	5	15	2.355	7,263

CRUZ HEMBRA/HEMERA

FEMALE/FEMALE
CROSS

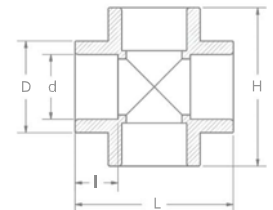

código	∅	d1	D	H	l	L	uds.bolsa	uds.caja	peso (gr)	€/U
code	(mm)	(mm)	(mm)	(mm)	(mm)	(mm)	units bag	units box	weight (gr)	€/U
853000020	20	20	27	52	14,5	53	10	80	1.819	2,020
853000025	25	25	34,5	59	16	59	10	50	1.936	2,217
853000032	32	32	42,5	71,5	18	71,5	10	30	2.026	3,089
853000040	40	40	53	83	20,5	83	4	16	1.750	6,722

TE CENTRO MACHO

MALE TEE CENTRE

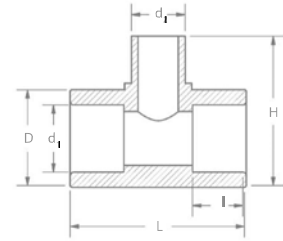

código	∅ (mm)	d1 (mm)	d2 (mm)	D (mm)	H (mm)	I (mm)	L (mm)	uds.bolsa	uds.caja	peso (gr)	€/U
code								units bag	units box	weight (gr)	€/U
844202020	20x20x20	20	20,3	30	45	14,5	52,5	10	80	1.887	0,834

CODO 90° MACHO/HEMBRA

MALE/FEMALE 90° ELBOW

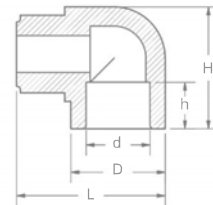

código	∅ (mm)	d (mm)	D (mm)	h (mm)	H (mm)	L (mm)	uds.bolsa	uds.caja	peso (gr)	€/U
code							units bag	units box	weight (gr)	€/U
833001616	16	16	25	13	34	33,5	10	150	1.607	0,899
833002020	20	20	30	14,5	39	49,5	10	100	2.016	0,795
833002525	25	25	34	16	43,5	57	10	100	2.818	1,129
833003232	32	32	43	18	56	59,5	10	40	2.115	1,819
833004040	40	40	53	20,5	67,5	71,5	6	24	2.096	3,021

CODO 45° MACHO/HEMBRA

MALE/FEMALE 45° ELBOW

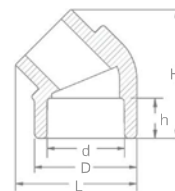

código	∅ (mm)	d (mm)	D (mm)	h (mm)	H (mm)	L (mm)	uds.bolsa	uds.caja	peso (gr)	€/U
code							units bag	units box	weight (gr)	€/U
834002020	20	20	29	14,5	48	39,5	10	100	1.566	0,950
834002525	25	25	34,5	16	46	41,5	10	80	1.569	1,287
834003232	32	32	43	18	56	52,5	10	40	1.575	1,908
834004040	40	40	52,5	20,5	65	61	6	24	1.589	3,157



**ACCESORIOS
ELECTROSOLDABLES
PP-R**

**ELECTROFUSION
PP-R FITTINGS**

MANGUITO ELECTROSOLDABLE

ELECTROFUSION
SOCKET

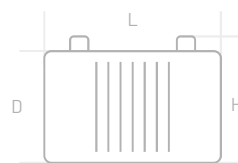

código	∅	H	L	D	uds.bolsa	uds.caja	peso (gr)	€/U
code	(mm)	(mm)	(mm)	(mm)	units bag	units box	weight (gr)	€/U
848000025	25	56	73	41	1	26	2.410	16,722
848000032	32	61,5	81	49	1	30	2.130	17,915
848000040	40	74	93	55,5	1	20	2.460	22,909
848000050	50	87,5	100,5	71,5	1	12	2.460	25,948
848000063	63	103,5	118	86	1	8	2.415	27,877
848000075	75	119	130	104,5	1	10	4.800	39,596
848000090	90	134,5	145	123,5	1	6	4.250	51,504
848000110	110	166	160	150	1	4	4.700	80,424
848000125	125	179,5	182	165	1	12	16.635	128,147
848000160	160	225	189,5	210,5	1	6	14.455	172,040
848000200	200	263	212,5	259	1	3	13.060	255,485
848000250	250	300	212	296	1	2	11.640	480,376
848000315	315	376	290	370	1	1	9.100	651,799

CODO 90° ELECTROSOLDABLE

ELECTROFUSION
90° ELBOW

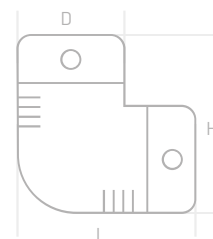

código	∅	H	L	D	uds.caja	uds.bolsa	peso (gr)	€/U
code	(mm)	(mm)	(mm)	(mm)	units box	units bag	weight (gr)	€/U
848100063	63	138	138	83	1	4	2.035	58,122
848100075	75	161	161	97	1	6	4.950	73,062
848100090	90	179	179	116	1	3	3.870	87,283
848100110	110	215	215	142	1	2	4.510	141,861
848100125	125	232	232	155	1	6	14.030	236,502
848100160	160	295	295	198	1	4	18.785	267,828



CODO 45° ELECTROSOLDABLE

ELECTROFUSION
45° ELBOW

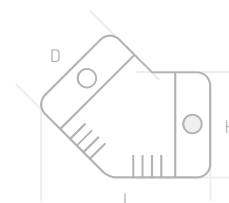

código code	∅ (mm)	H (mm)	L (mm)	D (mm)	uds.bolsa units bag	uds.caja units box	peso (gr) weight (gr)	€/U
848300063	63	125,5	160,5	86	1	4	1.830	54,293
848300075	75	146	183	106	1	6	4.180	87,731
848300090	90	168,5	205	124	1	3	3.200	120,396
848300110	110	203	238,5	150	1	2	3.590	185,662
848300125	125	216	249,5	161	1	8	15.135	232,904
848300160	160	278	321	211	1	4	15.530	276,640

TE ELECTROSOLDABLE ELECTROFUSION TEE

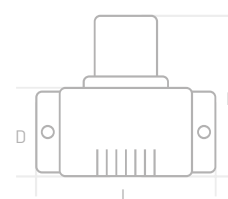

código code	∅ (mm)	H (mm)	L (mm)	D (mm)	uds.bolsa units bag	uds.caja units box	peso (gr) weight (gr)	€/U
848200063	63	165,5	177,5	100	1	3	2.275	61,008
848200075	75	186,5	188	114,5	1	3	3.380	98,825
848200090	90	209,5	225,5	134,5	1	2	3.590	106,863
848200110	110	247,5	246	164,5	1	7	18.515	143,035
848200125	125	260	275,5	178	1	5	17.240	245,108
848200160	160	320,5	365	220,5	1	3	19.240	275,470

REDUCCIÓN ELECTROSOLDABLE

ELECTROFUSION
REDUCER

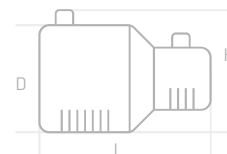

código code	∅ (mm)	Dn (mm)	H (mm)	L (mm)	uds.bolsa units bag	uds.caja units box	peso (gr) weight (gr)	€/U
848406332	63 - 32	82	98,5	127	1	8	1.815	34,315
848406340	63 - 40	82	98,5	126,5	1	8	1.885	35,245
848406350	63 - 50	82,5	100	124	1	8	2.090	42,971
848407563	75 - 63	98,5	114,5	138,5	1	5	1.940	48,537
848409063	90 - 63	126,5	138,5	154,5	1	3	2.060	53,176
848411063	110 - 63	149,5	165,5	191,5	1	15	16.660	98,519
848411075	110 - 75	143,5	160	176	1	21	17.565	99,238
848411090	110 - 90	150,5	165	178	1	16	18.430	103,361
848412590	125 - 90	160,5	179	184,5	1	16	17.540	142,005
848416011	160 - 110	209	220	217	1	6	13.885	174,912

CUELLO BRIDA LARGO

MALE STUB FALANGE

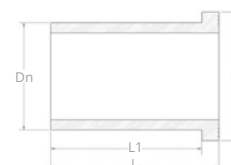

código	∅	Dn	H	L	L1	uds.bolsa	uds.caja	peso (gr)	€/U
code	(mm)	(mm)	(mm)	(mm)	(mm)	units bag	units box	weight (gr)	€/U
849110631	63	63	93	115	100	2	8	1.757	12,462
849110751	75	75	110,5	120	104	1	4	1.465	17,243
849110901	90	90	128,5	119,5	102,5	1	4	1.949	22,443

CUELLO BRIDA LARGO

MALE STUB FALANGE

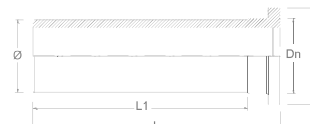

código	∅	Dn	H	L	L1	uds.bolsa	uds.caja	peso (gr)	€/U
code	(mm)	(mm)	(mm)	(mm)	(mm)	units bag	units box	weight (gr)	€/U
849111101	110	130	156	252,5	200	1	2	4.536	68,100
849112501	125	163	186,5	265	200	1	2	7.541	104,330

RACORD TRANSICIÓN HEMBRA

TRANSITION ADAPTER
FEMALE THREAD

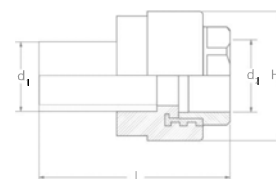

código	∅	d1	d2	H	L	uds.bolsa	uds.caja	peso (gr)	€/U
code		(mm)	(pulg / in)	(mm)	(mm)	units bag	units box	weight (gr)	€/U
848914040	40x1 1/4"	40	1 1/4"	75	128,5	3	18	1.437	31,495
848915050	50x1 1/2"	50	1 1/2"	80,5	171	3	15	7.788	38,097
848916363	63x2"	63	2"	92,5	180,5	2	8	5.485	43,070
848917575	75x2 1/2"	75	2 1/2"	119,5	177,5	1	6	6.585	85,628
848919090	90 - 3"	90	3"	143	221	1	3	6.177	150,578
848910110	110-4"	110	4"	157,5	260,5	1	3	8.367	190,607

RACORD TRANSICIÓN MACHO

TRANSITION ADAPTER
MALE THREAD



código	∅	d1	d2	H	L	uds.bolsa	uds.caja	peso (gr)	€/U
code	(mm)	(mm)	(pulg / in)	(mm)	(mm)	units bag	units box	weight (gr)	€/U
848924040	40x1 1/4"	40	1 1/4"	75	149,5	3	18	8.313	32,160
848925050	50x1 1/2"	50	1 1/2"	75,5	193,5	2	12	7.737	42,145
848926363	63x2"	63	2"	84,5	203	2	10	7.543	49,973
848927575	75x2 1/2"	75	2 1/2"	99,5	203	1	6	6.567	79,572
848929090	90 - 3"	90	3"	121,5	248	1	3	5.772	152,820
848920110	110-4"	110	4"	156,5	300,5	1	2	7.771	287,404